

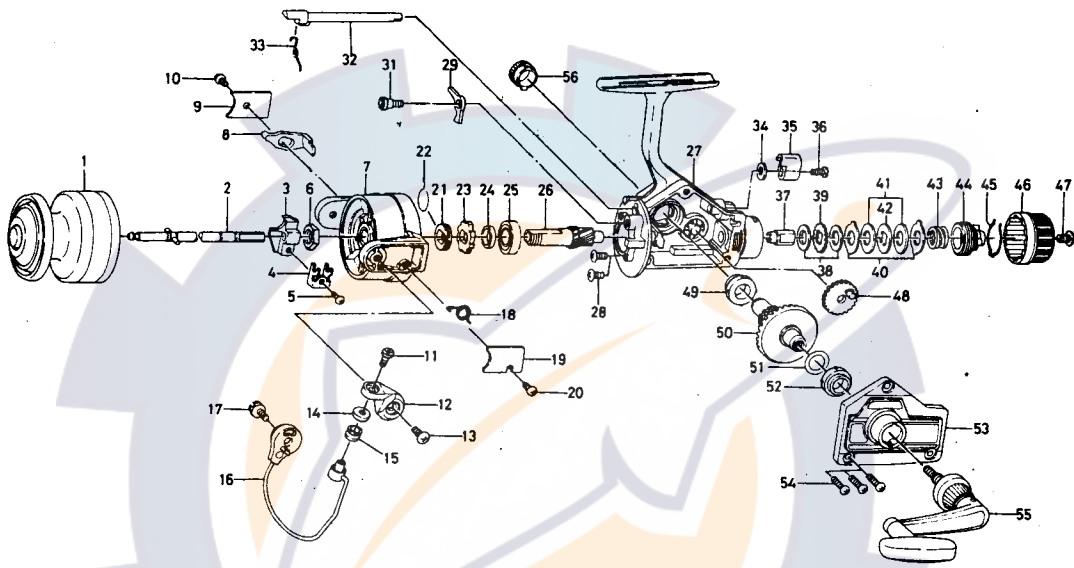

SPINNING REEL RG1350/RG1650



Key No.	Parts No.	Parts Name	Key No.	Parts No.	Parts Name
1	B67-7101	Spool	33	144-0321	Anti-reverse cam spring
2	B67-6101	Main shaft	34	371-6903	Anti-reverse lever washer
3	B67-6301	Oscillating slider	35	541-6801	Anti-reverse lever
4	B62-0801	Oscillating slider ret. plate	36	353-4401	Anti-reverse lever screw
5	351-1804	Oscillating slider ret. plate screw	37	B48-9802	Drag washer holder
6	B68-1701	Rotor nut	38	B48-9901	Drag washer A
7	B69-0101	Rotor	39	B49-0001	Click gear
8	B45-1001	Bail kick lever	40	B49-0101	Drag washer B
9	B68-1301	Bail kick lever cover	41	B49-0201	Drag washer C
10	352-0401	Bail kick lever cover screw	42	B49-0301	Drag washer D
11	B67-9302	Bail screw	43	B67-8501	Drag washer spring
12	B68-1101	Arm lever	44	B67-5601	Drag screw
13	351-6101	Arm lever screw	45	B67-5701	Drag washer retainer
14	B68-5702	Roller collar	46	B67-5801	Drag knob
15	250-3921	Line roller	47	352-1105	Drag knob screw
16	B68-1401	Bail	48	413-4501	Oscillating gear
17	351-6101	Bail holder screw	49	501-6101	Bearing
18	B18-7702	Bail spring	50	B70-7201	Drive gear
19	B68-1201	Bail spring cover	51	371-2800	Drive gear adjusting washer
20	352-0401	Bail spring cover screw	52	501-6101	Bearing
21	501-9901	Spring holder	53	B67-6403	Body cover
22	145-0901	Anti-reverse claw spring	54	351-8501	Body cover screw
23	280-9001	Ratchet	55	B48-0601	Handle
24	501-9801	Spacing sleeve	56	B68-2601	Handle screw cap
25	636-6011	Ball bearing	Special parts for RG1650		
26	B70-5701	Pinion gear	1	B67-8101	Spool
27	B67-3603	Body	7	B69-0201	Rotor
28	351-6102	Ball bearing screw	8	B45-7401	Bail kick lever
29	B74-5501	Anti-reverse claw	16	B68-6801	Bail
31	363-9301	Anti-reverse claw screw	27	B67-3604	Body
32	B67-4101	Anti-reverse cam	53	B67-6404	Body cover